



Duplex Connector Division

BNC Series

50 ohm 0-4 GHz/75 ohm 0-1 GHz

BNC coaxial connectors are miniature, lightweight and can operate satisfactorily up to 11 GHz. The connector is typically used in applications from DC to 4 GHz and yields low reflection in this frequency range.

BNC is one of the world's most popular RF connectors, widely used in computer networks, audio, video, data processing and telecommunications equipment because of its size and relatively low installed cost.

Cable terminations are available in crimp, clamp, solder and jacket quick twist configurations. The 2 stud bayonet lock coupling provides ease of connect and disconnect, making it ideally suited to applications such as test equipment.

Interface Dimensions

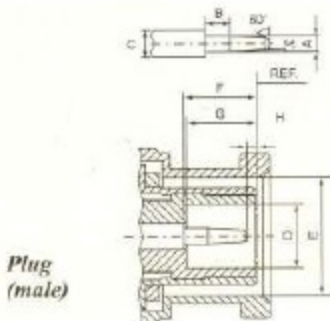

| | Plug | | Jack | |
|---|-----------|-----------|------------|------------|
| | min. | max. | min. | max. |
| A | 1.32/.052 | 1.37/.054 | 2.06/.081 | 2.21/.087 |
| B | 1.98/.078 | - | 4.95/.195 | - |
| C | 2.06/.081 | 2.21/.087 | 4.70/.185 | - |
| D | 4.83/.190 | - | - | 4.72/.186 |
| E | 9.78/.385 | 9.91/.390 | 8.10/.319 | 8.15/.321 |
| F | 5.33/.210 | 5.84/.230 | 9.60/.378 | 9.70/.382 |
| G | 5.28/.208 | 5.79/.228 | 10.97/.432 | 11.07/.436 |
| H | 0.08/.003 | - | 10.52/.414 | - |
| I | - | - | 8.31/.327 | 8.51/.335 |
| J | - | - | 4.72/.186 | 5.23/.206 |

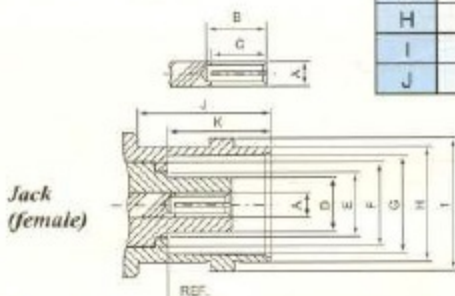

Electrical

| | | |
|-----------------|---|-----------|
| Impedance | 50 ohm | 75ohm |
| Frequency Range | 0 to 4.0 GHz | 0 to 1GHz |
| VSWR | Straight: 1.3max ; Right angle: 1.35max | |
| Insertion Loss | 0.2dB max @ 3GHz | |

BNC MALE, Crimp type
B-111

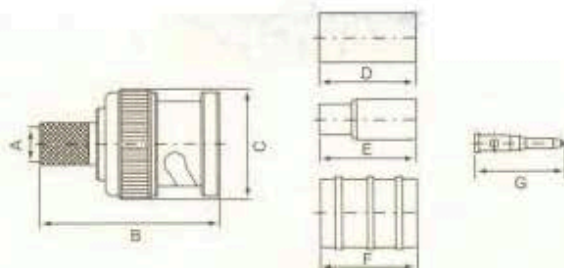

| PART NO. | Ω | CABLE TYPE | A | B | C | D | E | F | G |
|--------------|-------|--------------|------|------|------|------|------|------|------|
| B-111 | 50,75 | 2.5C-2V | 2.7 | 23.7 | 14.5 | 12.7 | / | / | 11.8 |
| B-111-124 | 50,75 | RG124U | 4.8 | 23.7 | 14.5 | / | / | 12.7 | 11.8 |
| B-111A | 50,75 | RG6U5.1 | 23.7 | 14.5 | 12.7 | / | / | 11.8 | / |
| B-111B | 50,75 | RG8U(213U) | 7.4 | 26.7 | 14.5 | 13.5 | / | / | 11.8 |
| B-111F | 50,75 | RG58U3.2 | 23.7 | 14.5 | 12.7 | / | / | 11.8 | / |
| B-111G | 50,75 | RG59U4.1 | 23.7 | 14.5 | 12.7 | / | / | 11.8 | / |
| B111L | 50,75 | RG174U(316U) | 2.7 | 23.7 | 14.5 | / | 12.7 | / | 11.2 |
| B-111L-1 | 50,75 | RG174U(316U) | 1.7 | 23.7 | 14.5 | 9.5 | / | / | 11.8 |
| B-111M | 50,75 | RG178U | 2.7 | 23.7 | 14.5 | / | 12.7 | / | 4.9 |
| B-111N | 50,75 | RG179U | 2.7 | 23.7 | 14.5 | / | 12.7 | / | 11.8 |
| B-111U | 50,75 | BT3002 | 3.2 | 23.7 | 14.5 | / | 12.4 | / | 11.8 |
| B-111-H155 | 50,75 | H155 4.5 | 23.7 | 14.5 | 12.7 | / | / | 11.8 | / |
| B-111-H155-1 | 50,75 | H155 4.2 | 23.7 | 14.5 | 12.7 | / | / | 11.8 | / |

BNC MALE, Crimp type
Two-pieces type
B-111/2PCS



| PART NO. | Ω | CABLE TYPE | A | B | C | D |
|-------------|-------|------------|-----|------|------|----|
| B-111A/2PCS | 50,75 | RG6U | 7.5 | 25.2 | 14.5 | 17 |
| B-111F/2PCS | | RG58U | | | | |
| B-111G/2PCS | | RG59U | | | | |

BNC MALE, Screw-on type
B-112

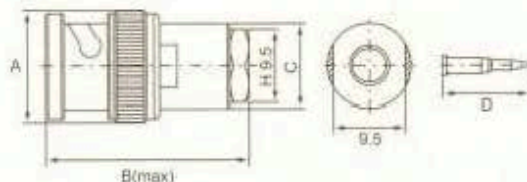

| PART NO. | Ω | CABLE TYPE | A | B | C | D |
|----------|-------|------------|------|------|----|------|
| B-112A | 50,75 | RG6U | 14.5 | 26.7 | 11 | 11.5 |
| B-112F | | RG58U | | | | |
| B-112G | | RG59U | | | | |
| B-112L | | RG174U | | | | |

BNC MALE, Screw-on type
B-112F-1 for RG58U

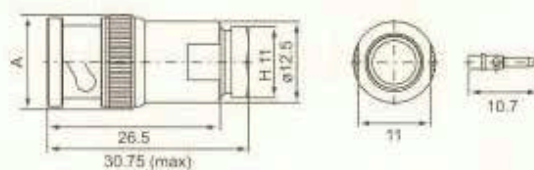

BNC MALE, Screw-on type
B-112B



| PART NO. | Ω | CABLE TYPE | A | B | C | D |
|----------|----------|------------|------|------|------|------|
| B-112B | 50,75 | RG213U | 14.5 | 41.2 | 17.5 | 11.8 |

BNC MALE, Twist-on type
B-113

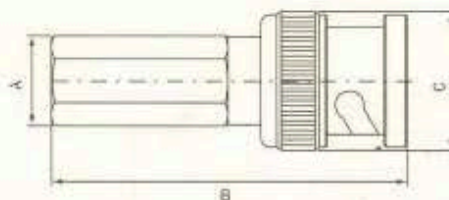

| PART NO. | Ω | CABLE TYPE | A | B | C |
|----------|----------|------------|-----|------|------|
| B-113A | 50,75 | RG6U | 9.5 | 36.3 | 14.5 |
| B-113F | | RG58U | | | |
| B-113G | | RG59U | | | |

BNC MALE, Twist-on type
B-1130

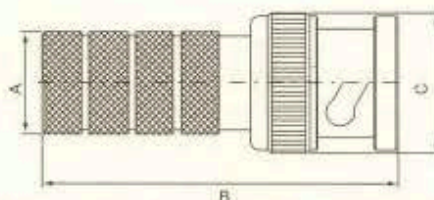

| PART NO. | Ω | CABLE TYPE | A | B | C |
|----------|----------|------------|------|------|------|
| B-1130F | 50,75 | RG58U | 10.5 | 36.3 | 14.5 |
| B-1130G | | RG59U | | | |

BNC MALE, Crimp type Right angle
B-121

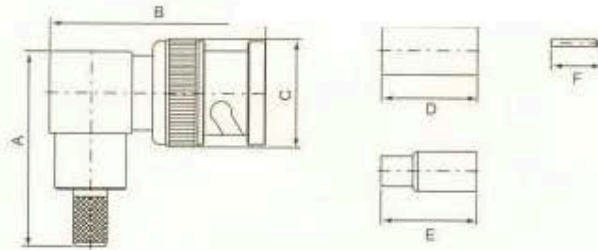

| PART NO. | Ω | CABLE TYPE | A | B | C | D | E | F |
|----------|----------|------------|------|------|------|------|------|-----|
| B-121A | 50,75 | RG6U | 26 | 28.7 | 14.5 | 12.7 | | |
| B-121F | | RG58U | | | | | | |
| B-121G | | RG59U | | | | | | |
| B121K | 50,75 | RG55U | 26 | 28.7 | 14.5 | 12.6 | | |
| B121L | 50,75 | RG174 | 26.1 | 28.7 | 14.5 | | 12.7 | 6.5 |

BNC MALE, Crimp type Right angle
B-121-00

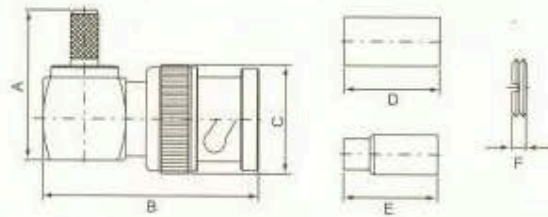

| PART NO. | Ω | CABLE TYPE | A | B | C | D | E | F |
|----------------------|----------|------------|----|------|------|------|---|-----|
| B-121F-00(soldering) | 50,75 | RG6U | 20 | 28.7 | 14.5 | 12.7 | | 1.9 |
| B-121G-00(soldering) | | RG58U | | | | | | |
| B-121L-00(soldering) | | RG59U | | | | | | |
| B-121U-00(soldering) | | RG59U | | | | | | |

BNC MALE, Screw-on type
Right Angle
B-122

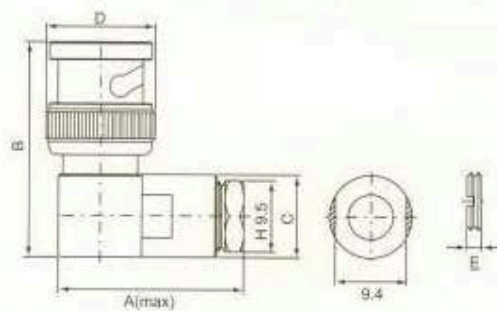

| PART NO. | Ω | CABLE TYPE | A | B | C | D | E |
|----------|----------|------------|------|------|----|------|-----|
| B-122A | 50,75 | RG6U | 24.6 | 28.7 | 11 | 14.5 | 1.9 |
| B-122F | | RG58U | | | | | |
| B-122G | | RG59U | | | | | |

BNC MALE, Twist-on type
Right angle
B-123

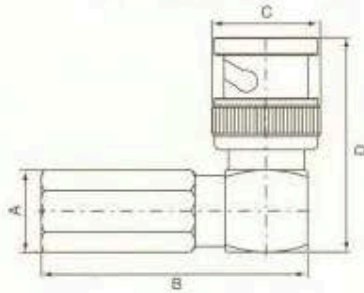

| PART NO. | Ω | CABLE TYPE | A | B | C | D |
|----------|----------|------------|-----|------|------|------|
| B-123A | 50,75 | RG6U | 9.5 | 35.4 | 14.5 | 28.7 |
| B-123F | | RG58U | | | | |
| B-123G | | RG59U | | | | |

BNC MALE, Solder type
Bulkhead receptacle
B-135 (50 Ω , 75 Ω)

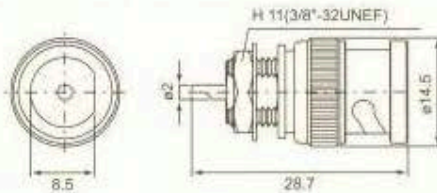

BNC MALE, Crimp type
Panel receptacle
B-141

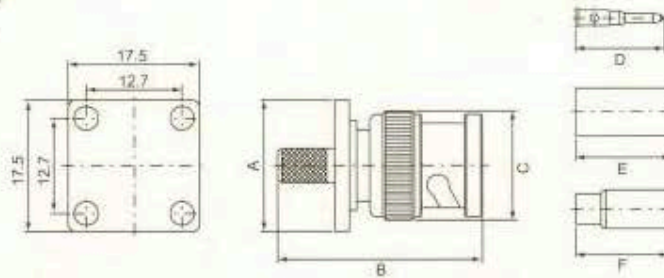

| PART NO. | Ω | CABLE TYPE | A | B | C | D | E | F |
|----------|----------|--------------|------|------|------|------|------|------|
| B-141A | 50,75 | RG6U | 17.5 | 27.2 | 14.5 | 11.8 | 12.7 | / |
| B-141F | | RG58U | | | | | | |
| B-141G | | RG59U | | | | | | |
| B-141L | 50,75 | RG174U(316U) | 17.5 | 27.2 | 14.5 | 11.8 | | 12.4 |

BNC MALE, Screw type
Panel receptacle
B-145 (50 Ω , 75 Ω)

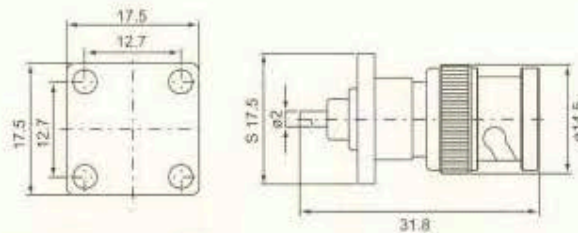

BNC FEMALE, Crimp type
B-211

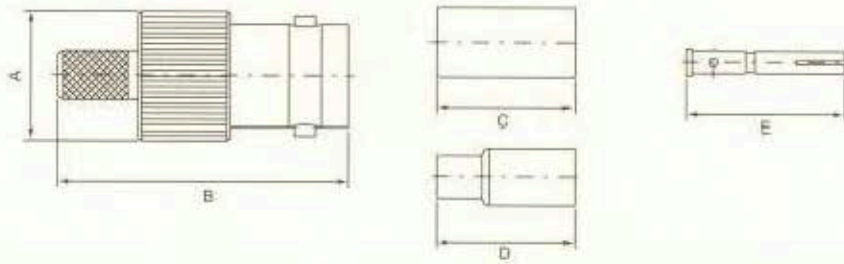

| PART NO. | Ω | CABLE TYPE | A | B | C | D | E |
|----------|----------|------------|----|----|------|------|------|
| B-211A | 50,75 | RG6U | 12 | 27 | 12.7 | 12.7 | 14.7 |
| B-211F | | RG58U | | | | | |
| B-211G | | RG59U | | | | | |
| B-211L | 50,75 | RG174U | 12 | 27 | | 12.7 | 14.7 |
| B-211U | 50,75 | BT3002 | 12 | 27 | 10 | | 14.2 |

BNC FEMALE, Crimp type Two-pieces type
B-211/2PCS

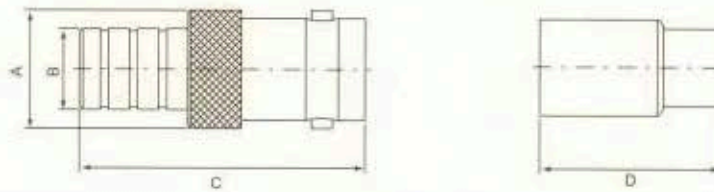

| PART NO. | Ω | CABLE TYPE | A | B | C | D |
|-------------|----------|------------|----|-----|------|----|
| B-211A/2PCS | 50,75 | RG6U | 11 | 7.5 | 26.5 | 17 |
| B-211F/2PCS | | RG58U | | | | |
| B-211G/2PCS | | RG59U | | | | |

BNC FEMALE, Screw-on type
B-212

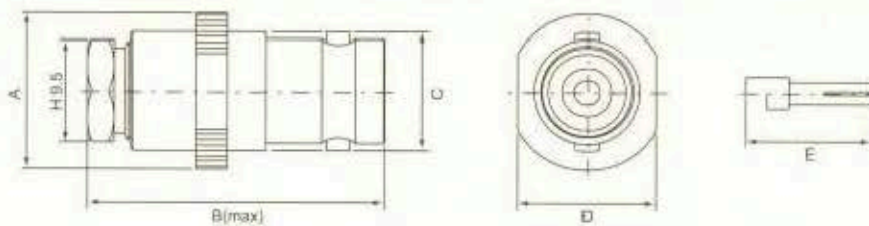

| PART NO. | Ω | CABLE TYPE | A | B | C | D | E |
|----------|----------|------------|------|------|----|------|------|
| B-212A | 50,75 | RG6U | 14.5 | 27.7 | 11 | 12.7 | 11.8 |
| B-212F | | RG58U | | | | | |
| B-212G | | RG59U | | | | | |

BNC FEMALE, Twist-on type
B-213

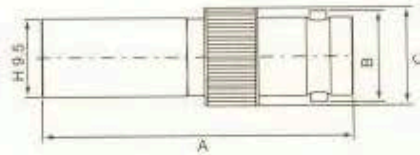

| PART NO. | Ω | CABLE TYPE | A | B | C |
|----------|-------|------------|----|----|----|
| B-213A | 50,75 | RG6U | 38 | 11 | 12 |
| B-213F | | RG58U | | | |
| B-213G | | RG59U | | | |

BNC FEMALE, Crimp type
Bulkhead receptacle
B-231

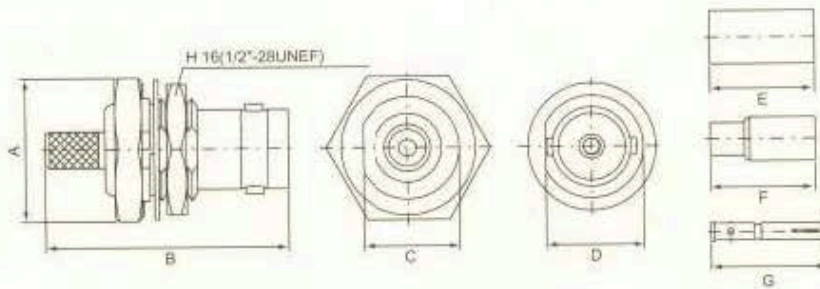

| PART NO. | Ω | CABLE TYPE | A | B | C | D | E | F | G |
|----------|-------|-------------|------|------|------|------|------|------|------|
| B-231A | 50,75 | RG6U | 17.5 | 29.5 | 11.8 | 11.8 | 12.7 | 12.7 | 14.7 |
| B-231F | | RG58U | | | | | | | |
| B-231G | | RG59U | | | | | | | |
| B-231L | 50,75 | RG174U,316U | 15.5 | 31.1 | | 11.8 | | 12.7 | 14.7 |

BNC FEMALE, Screw-on type
Bulkhead receptacle
B-232

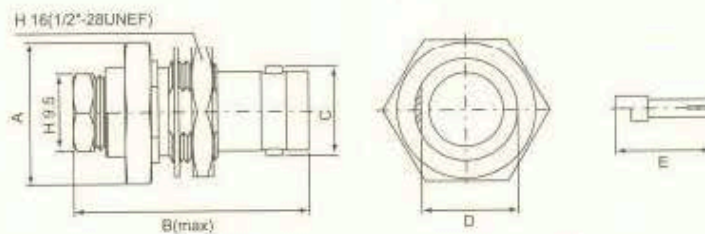

| PART NO. | Ω | CABLE TYPE | A | B | C | D | E |
|----------|-------|------------|------|------|----|------|------|
| B-232F | 50,75 | RG58U | 17.5 | 28.5 | 11 | 11.7 | 11.8 |
| B-232G | | RG59U | | | | | |

**Bulkhead receptacle
B-235**

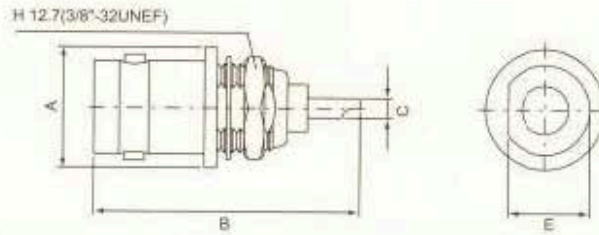

| PART NO. | Ω | CABLE TYPE | A | B | C | E | NOTE |
|----------|----------|------------|------|------|-----|-----|---------------------------|
| B-235 | 50,75 | BRASS | 12.5 | 27.4 | 2.1 | 8.5 | SOLDER LUG LOCK WASHER |
| B-235-2B | | | | | | | |
| B-235ZN | 50,75 | ZINC | 12.7 | 27.7 | 2.3 | 8.5 | |

**BNC FEMALE, Solder type
Bulkhead receptacle
Isolated ground
B-235-1 (50 Ω ,75 Ω)**

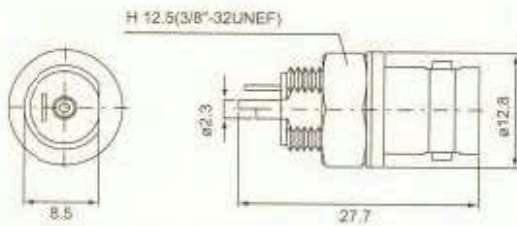

**BNC FEMALE
Dielectric color: Green, Blue, Red
B-235-2 (50 Ω ,75 Ω)**

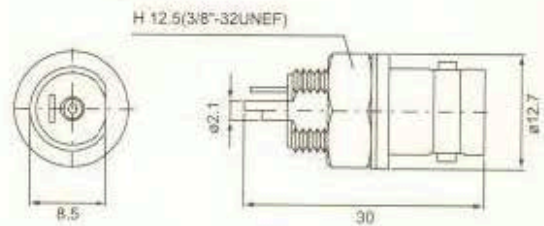

**BNC FEMALE, Solder type
Bulkhead receptacle
B-235-01B-D/D (50 Ω ,75 Ω)**

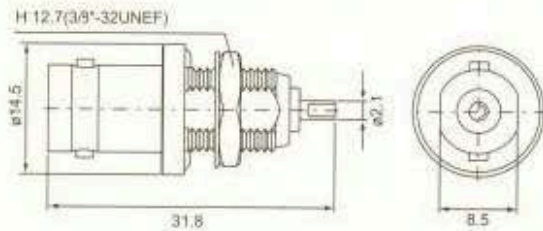

**BNC FEMALE, Crimp type
Bulkhead receptacle
B-2351L (50 Ω ,75 Ω)**

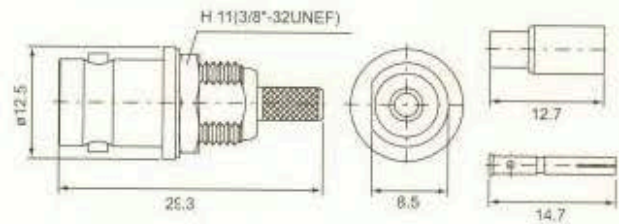

**BNC FEMALE, Crimp type
Bulkhead receptacle
B-235S-C (50 Ω ,75 Ω)**

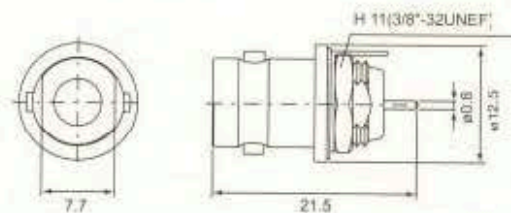

BNC FEMALE, Crimp type
Panel receptacle
B-241

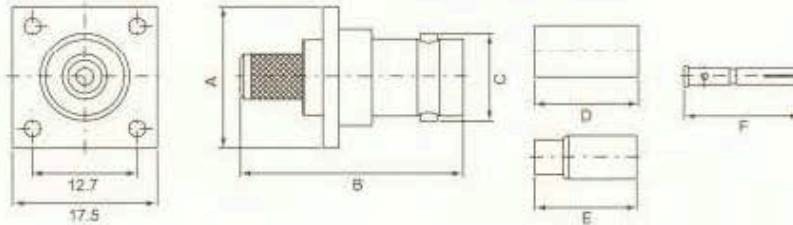

| PART NO. | Ω | CABLE TYPE | A | B | C | D | E | F |
|----------|----------|-------------|------|----|----|------|------|------|
| B-241A | 50,75 | RG6U | 17.5 | 27 | 11 | 12.7 | / | 14.7 |
| B-241F | | RG58U | | | | | | |
| B-241G | | RG59U | | | | | | |
| B-241L | 50,75 | RG174U,316U | 17.5 | 27 | 11 | | 12.4 | 14.7 |

BNC FEMALE, Screw-on type
Panel receptacle
B-242

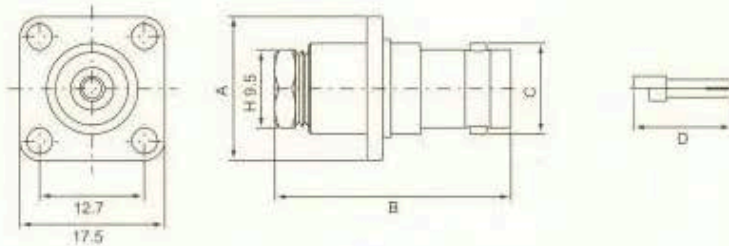

| PART NO. | Ω | CABLE TYPE | A | B | C | D |
|----------|----------|-------------|------|------|----|------|
| B-242A | 50,75 | RG6U | 17.5 | 24.5 | 11 | 11.8 |
| B-242F | | RG58U | | | | |
| B-242G | | RG59U | | | | |
| B-242L | | RG174U,316U | | | | |

BNC FEMALE, Solder type
Panel receptacle
B-245 (50 Ω ,75 Ω)

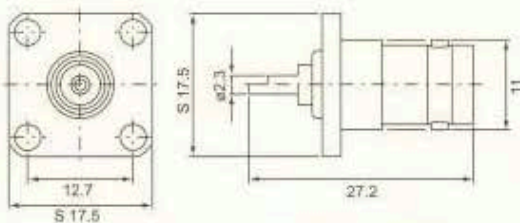

BNC FEMALE, Solder type
Right angle
Bulkhead receptacle
B-255 (50 Ω ,75 Ω)

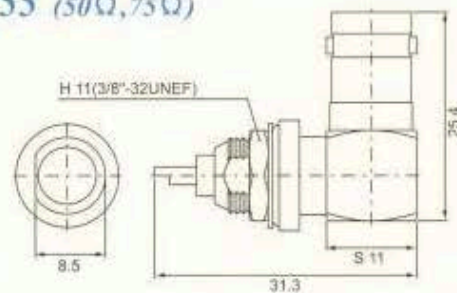

BNC MALE, Screw type
Panel receptacle
B-1450 (50Ω,75Ω)

B-1450-25.4 (50Ω,75Ω)

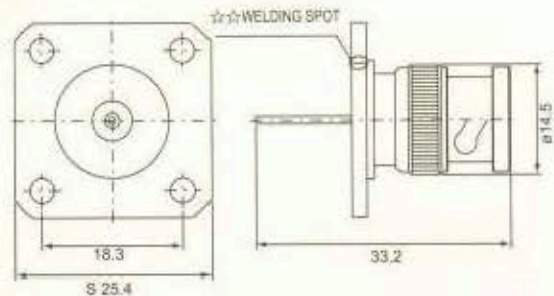
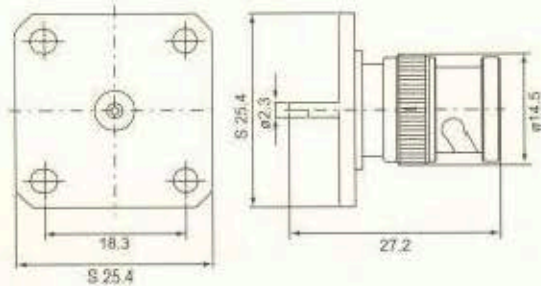

BNC FEMALE, Solder type
Panel receptacle
B-2450 (50Ω,75Ω)

B-2450-25.4 (50Ω,75Ω)

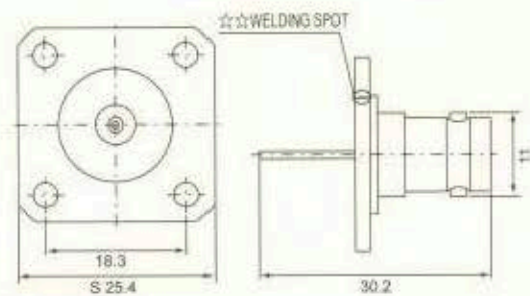
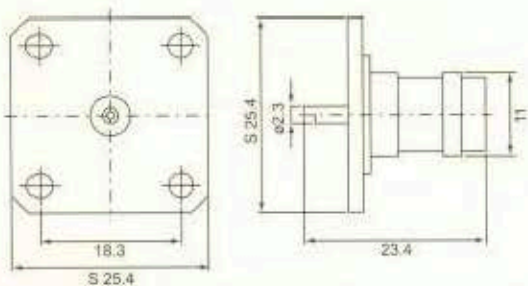

BNC FEMALE, crimp type
Right angle
B-265 (50Ω,75Ω)

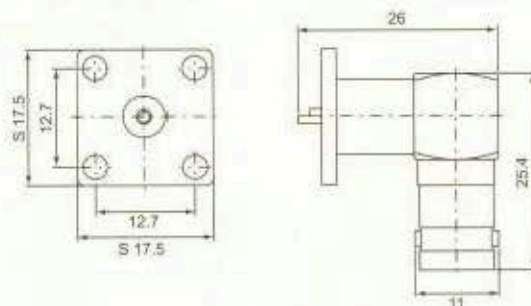

BNC MALE, Screw-on type
Right angle
B-L122

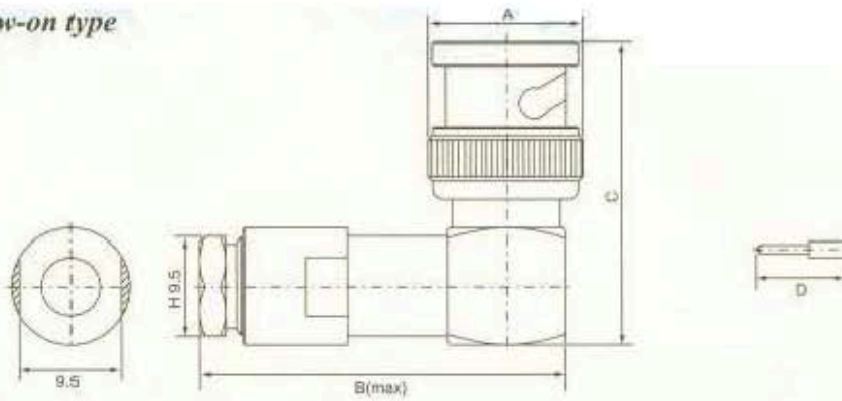

| PART NO. | Ω | CABLE TYPE | A | B | C | D |
|----------|----------|------------|------|------|------|-----|
| B-L122F | 50,75 | RG58U | 14.5 | 34.5 | 28.7 | 8.5 |
| B-L122G | | RG59U | | | | |

BNC MALE, Moulding type
B-M111F (50 Ω ,75 Ω)

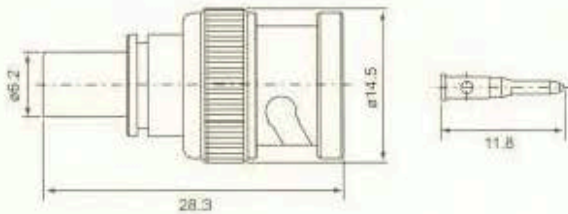

BNC MALE, Screw-on type
B-M112 (50 Ω ,75 Ω)

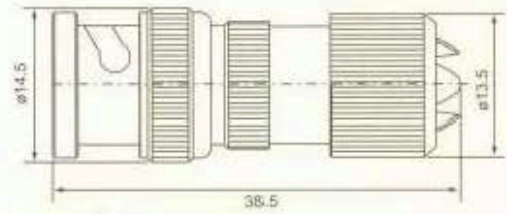

BNC MALE, Crimp type
B-P111

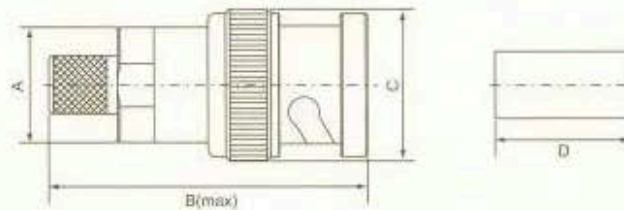

| PART NO. | Ω | CABLE TYPE | A | B | C | D |
|----------|----------|------------|----|------|------|------|
| B-P111A | 50,75 | RG58U | 11 | 30.1 | 14.5 | 12.7 |
| B-P111G | | RG59U | | | | |

BNC MALE, Screw-on type
B-P112

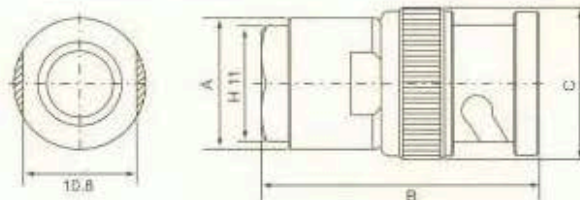

| PART NO. | Ω | CABLE TYPE | A | B | C |
|----------|----------|------------|------|------|------|
| B-P112A | 50,75 | RG6U | 12.5 | 26.2 | 14.5 |
| B-P112F | | RG58U | | | |
| B-P112G | | RG59U | | | |

**BNC FEMALE, Straight
PCB mount
B-P215**

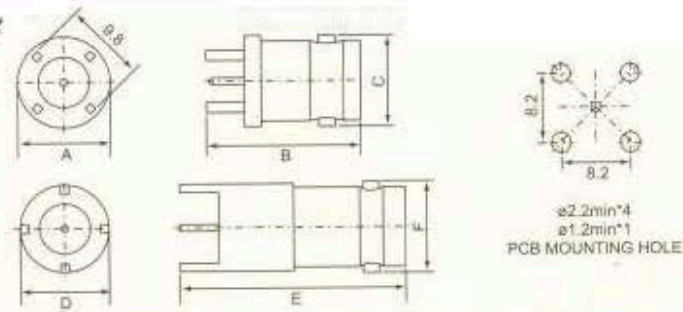

| PART NO. | Ω | CABLE TYPE | A | B | C | D | E | F |
|-------------|----------|--------------|----|------|----|------|----|----|
| B-P215-18.3 | 50,75 | WELDING SPOT | 11 | 18.3 | 11 | / | / | / |
| B-P215-27 | 50,75 | | / | / | / | 10.5 | 27 | 11 |

**BNC FEMALE, Straight PCB mount
B-P215-1A (50 Ω ,75 Ω)**

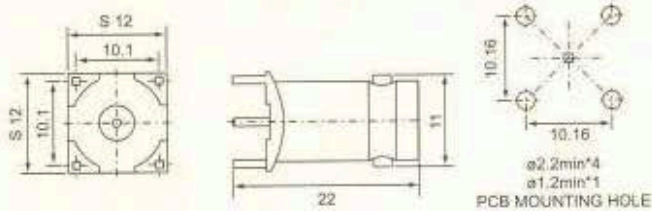

**BNC FEMALE, Straight PCB mount
B-P215-3A (50 Ω ,75 Ω)**

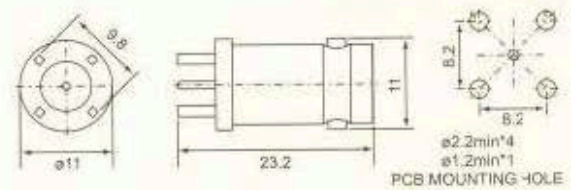

**BNC FEMALE, Straight PCB mount
B-P215-4A (50 Ω ,75 Ω)**

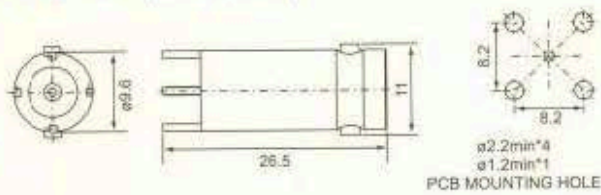

**BNC FEMALE, P.C.B mount
Right angle bulkhead receptacle
B-P225 (50 Ω ,75 Ω)**

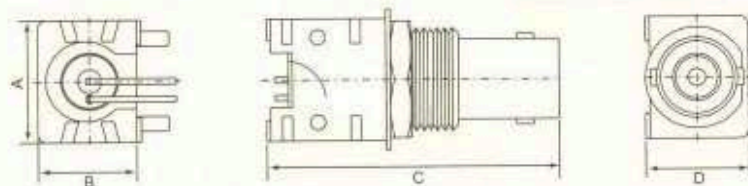
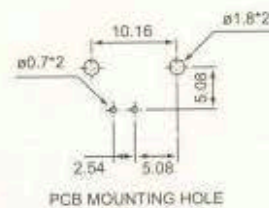

| PART NO. | Ω | CABLE TYPE | A | B | C | D |
|----------------|----------|-----------------------|------|------|------|------|
| B-P225/13.1-03 | 50,75 | Whole Metal: Zinc | 14.7 | 13.1 | 34.8 | 12.2 |
| B-P225/13.1-04 | 50,75 | PBT Mould, Brass Body | | | | |
| B-P225/13.1-05 | 50,70 | PBT Mould, Zinc Body | | | | |
| B-P225/15.8-03 | 50,75 | Whole Metal: Zinc | | 15.8 | | |
| B-P225/15.8-04 | 50,75 | PBT Mould, Zinc Body | | | | |
| B-P225/15.8-05 | 50,75 | PBT Mould, Zinc Body | | | | |

BNC FEMALE, P.C.B mount
Right angle bulkhead receptade
B-P2251 (50Ω,75Ω)

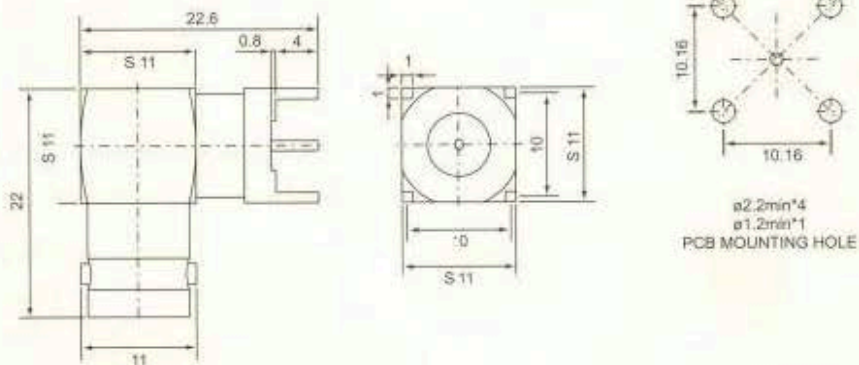

BNC FEMALE, P.C.B mount
Right angle bulkhead receptade
B-P225-1A (50Ω,75Ω)

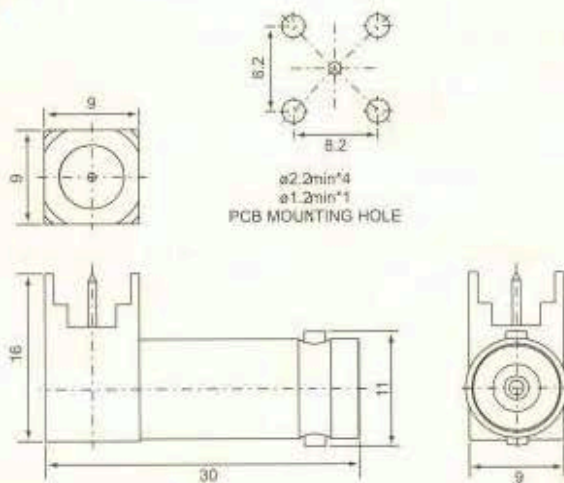

BNC FEMALE, P.C.B mount
Right angle bulkhead receptade
B-P232

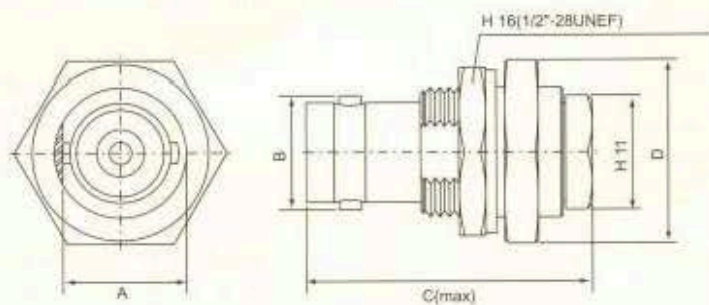

| PART NO. | Ω | CABLE TYPE | A | B | C | D |
|----------|-------|------------|------|----|------|------|
| B-P232A | 50,75 | RG6U | 11.7 | 11 | 27.3 | 17.5 |
| B-P232F | | RG58U | | | | |
| B-P232G | | RG59U | | | | |

Adaptors

Double BNC male
B-311 (50Ω,75Ω)

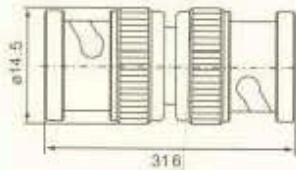

Double BNC female
B-322 (50Ω,75Ω)

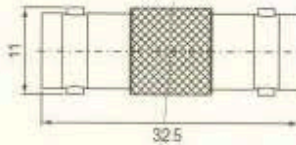

Double BNC female Bulkhead receptacle
B-332-1 (50Ω,75Ω)

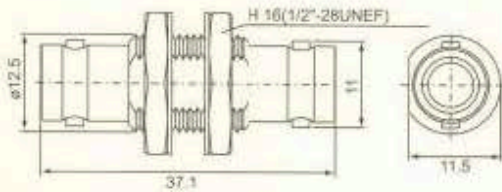

Double BNC female Panel receptacle
B-342 (50Ω,75Ω)

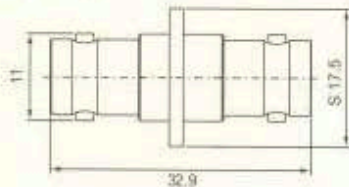

Three BNC male T-type
B-511 (50Ω,75Ω)

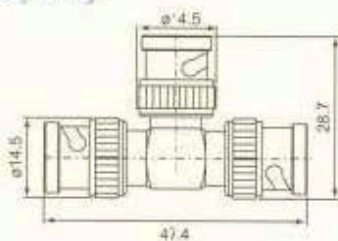

Single BNC male-double BNC female Special T-type
B-2512 (50Ω,75Ω)

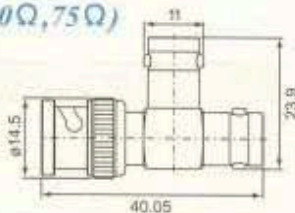

BNC male-BNC female
B-312 (50,75)

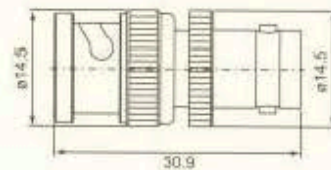

Double BNC female Bulkhead receptacle
B-332 (50Ω,75Ω)

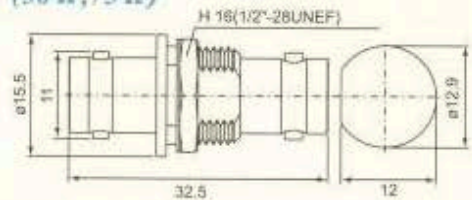

Double BNC female Insulated type Bulkhead receptacle
B-0332 (50Ω,75Ω)

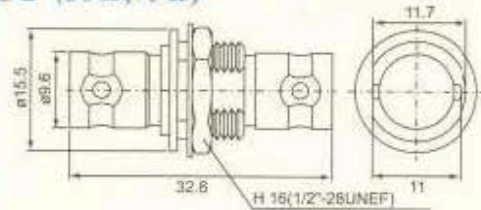

BNC male-BNC female
B-412 (50Ω,75Ω)

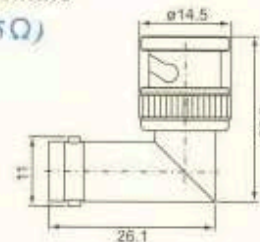

Single BNC male-double BNC female, T-type
B-512-01 / B-512-03
(50Ω,75Ω)

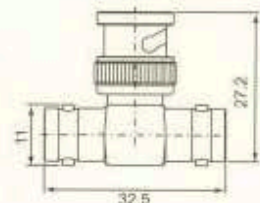

Single BNC male-double BNC female, F-type
B-F512 (50Ω,75Ω)

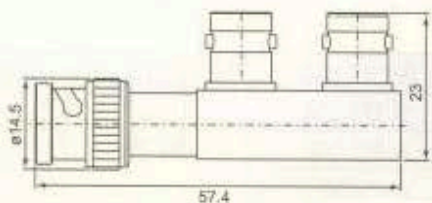

Single BNC male-double BNC female
L-type **B-L512**
(50Ω,75Ω)

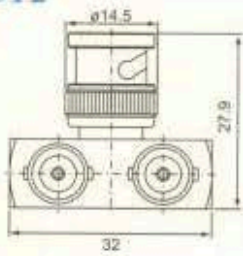

Single BNC male-double BNC female
(50Ω,75Ω) Y-type
B-Y512



Double BNC male-Single BNC female T-type
B-521 (50Ω,75Ω)

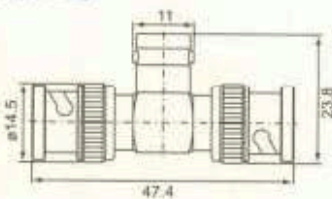

BNC male-F male
BF-311 (50Ω,75Ω)

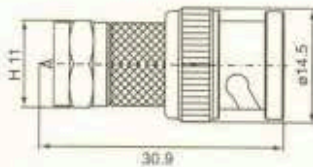

BNC female-F female
BF-322 (50Ω,75Ω)

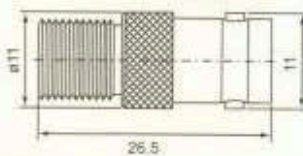

BNC male-N female
BN-312 (50Ω,75Ω)

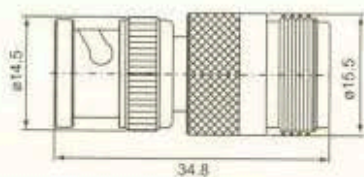

BNC male, Crimp type Y-type (50Ω,75Ω) for
RG58U, 59U
B-L5120

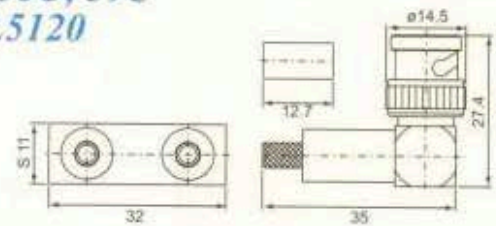

BNC male, crimp type Y-type (50Ω,75Ω) for
RG58U, 59U **B-Y5120**

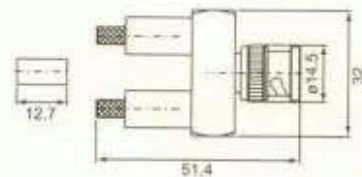

Three BNC female T-type (50Ω,75Ω)
B-522
B-522-ZN

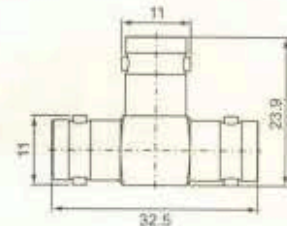

BNC male-F female
BF-312 (50Ω,75Ω)

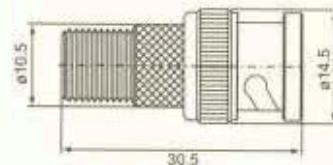

BNC male-mini UHF female
BM-312 (50Ω,75Ω)

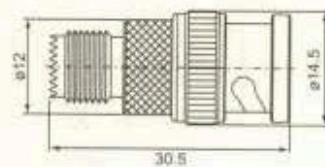

BNC male-RAC male
BR-311 (50Ω,75Ω)

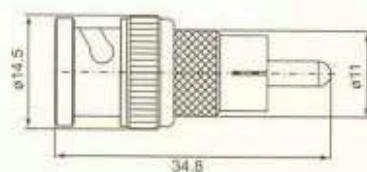

BNC male-RAC female
BR-312 (50Ω,75Ω)
BR-312-ZN

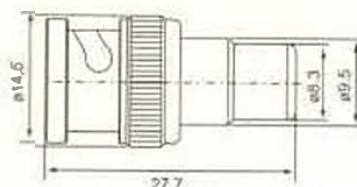

BNC male-TNC female
BT-312 (50Ω,75Ω)

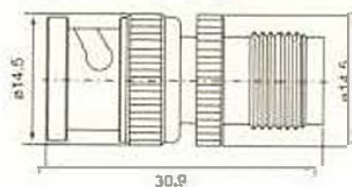

BNC female-TNC female
BT-322 (50Ω,75Ω)

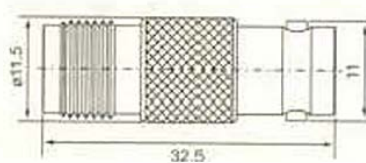

BNC male-UHF male
BU-311 (50Ω,75Ω)

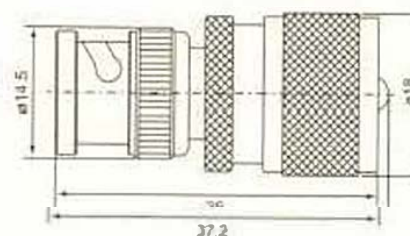

BNC male-UHF female
BU-312 (50Ω,75Ω)

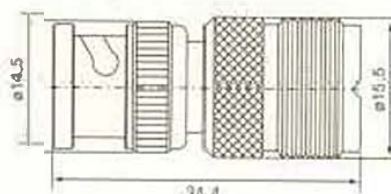

BNC female-UHF female
BU-322 (50Ω,75Ω)

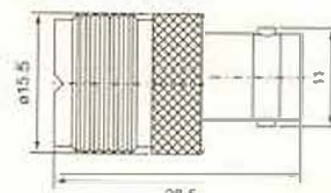

For further information contact us now:

Tel: 00 44 (0)1480 406206



sales@duplexcsa.com
www.duplexcsa.com

